

KENKOLIGHT™ FULL-SPECTRUM DESK LAMP

QUICK REFERENCE SHEET



- *Simulates natural sunlight*
- *Balanced, broad spectrum of visible light*
- *Enhanced blue wavelengths*
- *Flicker-free LED operation*
- *Environmentally friendly*
- *Clock with sunrise lighting and alarm*
- *Fully adjustable brightness control*
- *USB charging port*

KenkoLight

- 1 Full-spectrum LED array
- 2 Diffuser/two-position support
- 3 LED array on/off button and brightness control
- 4 Clock display
- 5 Clock, sunrise and alarm controls
- 6 USB port and power supply

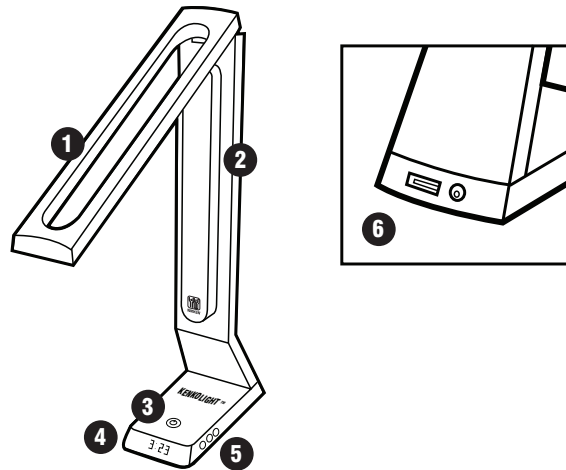

KENKOLIGHT FEATURES/BENEFITS:

- **Full-spectrum illumination** A natural balance of wavelengths (and additional blue) that create a natural-light environment indoors, at any time.
- **Simulates solar light without UVA and UVB** Benefits of sunlight without negative exposure.
- **Advanced LED technology** Eliminates flicker cycles that can cause eyestrain.
- **Folding support with light diffuser** For using KenkoLight as a lamp (open) or nightlight/accent light (closed).
- **Sunrise timer that gradually increases illumination** ... Helps support natural waking cycle.
- **Energy efficient** Uses less than 30% of the power required for a standard incandescent bulb.
- **Environmentally responsible** Long component life, no heavy metals for improved recyclability.

KENKOLIGHT™ FULL-SPECTRUM DESK LAMP

QUICK REFERENCE SHEET



THE FACTS

- Human beings thrive under natural sunlight. But much of modern living is spent indoors during daylight hours. Especially during the winter months, we may receive only minimal exposure to the frequencies of light that are responsible for life on Earth and which science has shown can help support physical well-being and emotional health.
- The KenkoLight provides illumination in a broad, balanced spectrum of wavelengths, including those which correspond to natural solar energy. This contrasts with incandescent or fluorescent bulbs, which provide light in uneven or incomplete energy ranges.
- Scientific evidence suggests that the application of balanced full-spectrum lighting can promote a healthy, normal sleep/wake cycle. Research findings support the hypothesis that exposure to this light in the early evening can help older adults sleep better at night. Other studies indicate that full-spectrum illumination may help in improving sleep and learning ability in adolescents.
- The KenkoLight range of wavelengths includes an increased amount of blue light, which is identified as having a potentially positive effect on normal circadian rhythm.
- Unlike the sun, the KenkoLight produces no potentially harmful UV rays. Ultraviolet light has been linked to premature skin aging and skin cancer. Some full-spectrum lamps emit UV energy, which limits safe use to brief periods. The KenkoLight may be employed as an everyday indoor light source to afford the benefits of sunlight without the dangers.
- Fluorescent light tubes and incandescent bulbs operate at frequencies that create a flickering effect. This flicker has been identified as causing a feeling of fatigue and eyestrain. The LEDs that produce the KenkoLight illumination are based on a completely different technology designed to reduce or eliminate flicker and glare.
- In addition to superior lighting characteristics, this form of lighting is much more energy efficient. A conventional 40-watt incandescent bulb consumes more than three times the electricity needed to power the KenkoLight.
- KenkoLight includes a digital clock display and a selectable, timer-activated brightening function that replicates sunrise or dawn. This can promote a more natural waking and sleep cycle. If desired it may be augmented by the built-in audible alarm.
- This type of lamp will also last longer. Under typical conditions the expected service life of 35,000 hours is equivalent to 10-15 years of use. This is approximately 10 times longer than a fluorescent tube and 60 times as long as a light bulb.
- The KenkoLight is more environmentally friendly than other types of lighting not only because its long service life means fewer discarded components, but also in that it does not present the toxic waste-disposal problems that are a concern with mercury-containing fluorescent tubes.

SPECIFICATIONS

Brightness	340+ lumens
Intensity	600 lux at 40 cm distance
Frequency	12,000 MHz maximum
CRI value	90+
Effective LED life	35,000 hours
Power consumption	12 W, maximum
Output (USB)	USB 2.0, 5 V, 500 mA

Dimensions

Head length	11.8 in/30 cm
Height	15.7 in/40 cm
Base length	6.3 in/16 cm
Base width	3 in/7.8 cm
Weight	2.1 lb/1 kg

PRODUCT INFORMATION

ITEM CODE	DESCRIPTION
#1297	KenkoLight full-spectrum desk lamp
AVAILABILITY	
US: YES	CN: YES
FEATURED NIKKEN TECHNOLOGY	
Advanced LED technology	
Broad-spectrum illumination	
WEIGHT	
3.9 lb/1.8 kg	
CARE INSTRUCTIONS	
See instruction manual	
HOW TO USE	
Connect adapter to standard AC current outlet.	
WARRANTY INFORMATION	
One-year limited warranty	

QUICK SHARING TIPS

Ask your prospect if a gloomy, gray day can contribute to feelings of depression. Compare that to bright sunshine. Then point out that an ordinary interior light cannot produce the same wavelengths as the sun, but the KenkoLight does.